

BCA Section J Deemed to Satisfy Compliance Report

2019

892-894 Canterbury Road Roselands NSW 2196

Ground Floor Commercial Areas of the Mixed Use Development

Report No. EC 3857-DTS – Rev 2
Compilation Date: 06/02/2022
Prepared By: Manuel Basiri
Eco Certificates Pty Ltd

BCA Section J Deemed to Satisfy Compliance Report

Building Code of Australia Volume 1 – 2019 – Amendment 1

892-894 Canterbury Road Roselands NSW 2196

Prepared under instructions from

Architecture Design Studio

By

Manuel Basiri

Eco Certificates Pty Ltd

info@ecocertificates.com.au

T: 1300 16 24 36

PO Box: 5172 South Turramurra NSW 2074

<https://work.gemma.app/Business/QuoteRequest/Ecocertificates>

CERTIFICATION

This report has been authorised by Eco Certificates Pty Ltd, on behalf of the Client with input and information provided to us by the Client of this report. Eco Certificates Pty Ltd has relied on the accuracy of the information contained in each of the referenced documents and reports and takes no responsibility for any errors or faults in those documents. The comments herein have been based upon information and facts that were correct at the time of writing this report. While we have tried to ensure the accuracy of the information in this publication, the Publisher accepts no responsibility or liability for any errors, omissions or resultant consequences including any loss or damage arising from reliance in information in this publication.

Manuel Basiri

BCA Section J DTS Consultant
JV3 Computer Energy Modeller
B.Sc – M.Sc
DMN Accredited Assessor



This document is Copyright. Apart from any fair dealings for the purposes of private study, research, criticism or review, as permitted under the Copyright Act, no part may be reproduced in whole or in part, without the written permission of Eco Certificates Pty Ltd. It contains commercial information which has been prepared only for the attention of the Client of this project. It is confidential in nature and no information contained in this document shall be released in part or whole to any third party without the approval of Eco Certificates Pty Ltd.

Document Version 2021.06

CONTENTS

| | |
|---|----|
| 1.0 INTRODUCTION | 4 |
| 1.1 DEFINITIONS..... | 5 |
| 1.2 REFERENCED DOCUMENTS | 6 |
| 1.3 PROPOSED DEVELOPMENT DETAILS..... | 7 |
| 2.0 BCA SECTION J DEEMED TO SATISFY COMPLIANCE PROVISIONS..... | 8 |
| 2.1 PART J 1 – BUILDING FABRIC..... | 8 |
| 2.1 APPLICABLE PART J 1 DTS PROVISIONS..... | 14 |
| 2.2 PART J 3 –BUILDING SEALING..... | 15 |
| 2.2 APPLICABLE PART J 3 DTS PROVISIONS..... | 18 |
| 2.3 PART J 5 – AIR CONDITIONING AND VENTILATION SYSTEMS..... | 19 |
| 2.4 PART J 6 – ARTIFICIAL LIGHTING AND POWER..... | 19 |
| 2.4 APPLICABLE PART J 6 DTS PROVISIONS..... | 25 |
| 2.5 PART J 7 – HEATED WATER SUPPLY AND SWIMMING POOL AND SPA POOL PLANT | 26 |
| 2.6 PART J 8 – FACILITIES FOR ENERGY MONITORING | 26 |
| 2.6 APPLICABLE PART J 8 DTS PROVISIONS..... | 28 |
| 3.0 SUMMARY AND CONCLUSIONS | 29 |
| 4.0 APPENDIX | 35 |

1.0 INTRODUCTION

The National Construction Code (NCC) is a performance-based code containing all Performance Requirements for the construction of buildings in Australia. It is a set of technical design and construction provisions for buildings which is an initiative of the COAG. It is produced and maintained by the ABCB on behalf of the Australian Government and each State and Territory government. As a performance-based code, it sets the minimum required level for the safety, health, amenity, accessibility and sustainability of certain buildings. A building solution will comply with the NCC if it satisfies the Performance Requirements, which are the mandatory requirements of the NCC.

Energy efficiency means improving the performance of services and systems that directly consume energy (such as lighting, air-conditioning and heating) and having greater control over the way that heat flows into and out of the building through its fabric.

The building sector is one of the fastest growing GHG emissions sources. Energy used in buildings accounts for more than 20% of all energy-related GHG emissions. Improving the energy efficiency of buildings therefore represents one of the biggest opportunities to reduce GHG emissions in Australia. The use of renewable or low GHG intensity fuels can also reduce the GHG emission rate.

For the purposes of the NCC energy efficiency requirements, “energy” is the electricity (taken both from the electricity grid and generated onsite), gas, oil or other fuels used in buildings for heating, cooling or ventilation, for lighting or heated water supply or to operate other building services.

Burning coal, natural gas and other fuels to produce electricity releases GHG’s into the atmosphere unless the source is one of the few considered renewable sources. Renewable sources include photovoltaic (solar) cells, hydroelectric and wind driven generators. Even these sources will be responsible for emissions at some part of their life cycle. The NCC recognises low-emitting energy sources through its Performance Requirements, Verification Methods and DTS Provisions. Since most of the energy consumed in buildings comes from GHG emitting sources, reducing energy use will also reduce emissions and their unwanted impacts.

NCC allows on-site renewable energy sources and re-claimed energy from another process to be deducted from the annual GHG emissions of the proposed building. This means that the “annual greenhouse gas emissions” are the sum of the GHG emissions drawn annually from the electrical grid, the gas network or fuel brought in by road transport and not the total of the energy consumed by the services that use energy.

To obtain this concession, the renewable energy must be used and generated on-site. This means that electricity purchased as GreenPower® for example does not comply with the concession as it is grid distributed. Energy that is exported to the grid cannot be used as part of this concession. A performance-based study like JV3 alternative solution using computer modelling is required in order to calculate the effect of on-site renewable energy source to improve the energy efficiency performance of a building.

The energy efficiency requirements are generally based on eight broadly defined climate regions, termed the NCC climate zones. The energy efficiency requirements will vary from location to location depending upon the climate zone. Each climate zone will have similar thermal requirements irrespective of the State or Territory where the building is located.

Three options are available to demonstrate compliance with the Performance Requirements of the NCC:

- A Performance Solution,
- A DTS Solution, or
- A combination of a Performance Solution and a DTS Solution.

This report presents the findings from the design assessment of the Proposed Development against the Deemed-to-Satisfy (DTS) requirements of Section J of the Building Code of Australia 2019, ENERGY EFFICIENCY.

The purpose of this report is to provide an assessment of the design plans and documentation for the Proposed Development and to list all the necessary provisions and upgrades in order for the development to comply with the requirements of the section J. The scope of this report is limited to the design documentation referenced in Section 2 of this report and only covers Section J of the BCA 2019 provisions.

1.1 DEFINITIONS

The term Proposed Development in this report refers to the ground floor commercial areas of the proposed mixed-use building located at 892-894 Canterbury Road Roselands NSW 2196.

Rapid roller door means a door that opens and closes at a speed of not less than 0.5 m/s.

A colour rendering index (CRI) is a quantitative measure of the ability of a light source to reveal the colours of various objects faithfully in comparison with an ideal or natural light source. Light sources with a high CRI are desirable in colour-critical applications.

The Kelvin based CCT (Correlated Colour Temperature), is a scale used in lighting to measure the colour temperature of a luminaire. The lower the number, the warmer the light will be and the higher the number, the cooler and bluer the light will appear. A typical incandescent bulb has a colour temperature between 2700K and 3000K. The sun at noon on a clear day produces a light of approximately 5500K.

1.2 REFERENCED DOCUMENTS

The following documents and design plans have been referenced in compilation of this report:

- National Construction Code Series, Volume 1 – Amendment 1, Building Code of Australia 2019, Class 2 to Class 9 Buildings and BCA Volume One Amendment 1.
- NCC 2019 Guide to BCA Volume One, Release date: May 2019
- Handbook: Energy Efficiency NCC Volume One, Publish date: Jun 2019 Print version: 6.0
- Architectural Plans provided by "[Architecture Design Studio](#)" and received by Eco Certificates Consultants at 19/01/2022.
- Email correspondence and response to information request received from the architects of the Proposed Development.

1.3 PROPOSED DEVELOPMENT DETAILS

The Proposed Development is in BCA Climate Zone 5 according to BCA Climate Map for NSW. It is considered a class 6 building according to the BCA standard classification being a mixed use building.

The following construction elements are being proposed in the building design according to architectural plans and design documents referenced in this report:

External Walls: lined masonry or concrete construction assumed.

Roof and Ceiling: plasterboard ceiling and concrete slab roof of ground floor conditioned commercial spaced under the balcony of level 1 units and outside air.

Internal Walls: lined masonry or concrete construction assumed for internal walls of ground floor conditioned areas adjacent to other unconditioned internal areas of the ground floor.

Floors: concrete slab on top of basement car park for conditioned areas of ground floor commercial spaces.

Windows: Standard Aluminium frame single glazed shop front windows and glazed doors assumed.

Skylights: no skylights proposed.

Air Conditioning System: no design plans provided.

Lighting System: no design plans provided.

2.0 BCA SECTION J DEEMED TO SATISFY COMPLIANCE PROVISIONS

This section analyses the current elements of the of Proposed Development design against the Deemed to Satisfy provisions of Section J of the Building Code of Australia 2019, Energy Efficiency. In case of a non-complying element, advisory notes are provided to bring the building in compliance with Section J DTS requirements.

A summary note of these provisions is provided in the Conclusion Section of this report that can be incorporated into specification blocks of architectural plans and, as a result, be easily referenced and followed during construction. It is however the responsibility of the entity responsible for the submission of the design plans and documents to the council to ascertain each and every element of this report is clearly referenced and reflected on the submitted plans and documents and not only the narrative of the Conclusion Section.

2.1 PART J 1 – BUILDING FABRIC

GENERAL NOTES

The Deemed-to-Satisfy Provisions of PartJ1 apply to building elements that form part of the envelope, where the envelope separates a conditioned space or habitable room from the exterior of the building or a non-conditioned space. This includes roofs, walls, glazing and floors as per the definition of “fabric” in the BCA.

An essential aspect of energy efficiency for a building is to ensure that the building is constructed in a manner that provides an adequate level of comfort for occupants so that they feel less need for artificial heating or cooling. This can be achieved by creating a thermally effective building envelope. This also means that when artificial heating or cooling is needed, the envelope will be more effective at retaining the conditioned air due to the thermal barrier between the internal and external (non-conditioned) environment. This is even more important in a commercial building that is likely to be air-conditioned for much of the time.

The intent of the building fabric DTS Provisions in Part J1 is to ensure that the construction around the conditioned spaces has a sufficient level of thermal performance to ensure energy is not used unnecessarily due to the influence of the external environment.

INSULATION

Insulation is to be fitted tightly to each side of framing members but need not be continuous over the framing member. The insulation requirements are calculated for parts of the roof, walls or floor that are clear of any framing members.

The provisions also state that the installation of insulation should not interfere with the safety or performance of domestic services and fittings such as heating flues, recessed light fittings, transformers for low voltage lighting, gas appliances and general plumbing and electrical components. This includes providing appropriate clearance as detailed in relevant legislation and referenced standards such as for electrical, gas and fuel oil installations.

For reflective insulation to achieve its tested R-Value, the airspace adjoining the insulation needs to be a certain width. Reflective insulating performance is achieved by the ability of the reflective insulation to “reflect” heat at one surface and not transmit it at another, combined with the insulating qualities of the thin air films adjacent to the reflective insulation. Reflective insulation must closely fit against any penetration or door or window opening and must be supported by a wall frame. Overlapping of reflective insulation should be at least 50 mm, otherwise it must be taped together. This aligns with the requirements of Standard AS/NZS 4200, the standard covering the installation of pliable building membranes.

The R-Value of bulk insulation is reduced if it is compressed. The allocated space for bulk insulation is therefore to allow the insulation to be installed so that it maintains its correct thickness unless exempted such as at wall studs. Some reflective insulation is also bonded to bulk, board or other insulation, providing enhanced performance of the composite system. The term “bulk insulation” includes glass fibre, wool, cellulose fibre, polyester and polystyrene foam. These materials tend to have a high percentage of air voids within the insulation that are fundamental to their ability to limit heat flow. The thermal performance of bulk insulation depends on the material retaining the depth specified by the manufacturer, in accordance with the required test results. The depth of the insulation is critical because of the need to retain the air pockets within the material. If the insulation is compressed, it will lose some of these air pockets as the fibre contact increases, which in turn will reduce its capacity to achieve the tested R-Value.

The requirement recognises that the practical limitations of maintaining the position and thickness of bulk insulation where it is likely to be compressed between cladding, supporting members, water pipes and electrical cabling. In these instances, compression of the bulk insulation may occur but should be limited where possible.

To ensure the performance of materials is correctly validated, test reports complying with AS/NZS 4859.1 should be provided in accordance with Part A5 of NCC Volume One and this documentation forms an integral part of the building approval. This standard specifies the testing criteria for insulation including both reflective and bulk insulation products.

Manufacturer's data sheets should be utilised by both building designers and building surveyors as documentary evidence of the performance of the insulation and may be required to form part of the building approval documentation.

CEILING AND ROOF

Where the ceiling space below the roof is used as the return air plenum, it is considered part of the conditioned space. In this instance, the envelope boundary for the roof and ceiling construction is located at the roof.

Insulation can be installed in the roof, the ceiling, or a combination of both provided the required thermal performance is achieved and other aspects of the building's integrity are not compromised. It should be noted that the thermal performance of the roof may vary depending on the position of the insulation, the climatic conditions, the design of the building and the way in which it is operated.

A ventilated roof space can be a roof space with vents that allow air to flow freely without obstructions, ensure there are no spaces with no air movement and have a fixed open area of at least 1.0% of the ceiling area. A ventilated roof space could also be a roof space with at least 2 wind-driven roof ventilators with a total opening area of at least 0.14 m². This requirement must be accompanied by vents with a total fixed open area of at least 0.2% of the ceiling area. A ventilated roof space can also be a roof space that is tiled and has no sarking-type material at roof level.

Solar absorptance refers to the proportion of solar radiation that is absorbed by the material. A lower solar absorptance will reflect more heat than a roof with a higher solar absorptance and is therefore usually a lighter colour. Colours with a greater solar absorptance allowance in the DTS provisions will require Performance Solutions like JV3 alternative solution.

WALLS AND GLAZING

For energy flow through the envelope, glazing is often the greatest path of heat transfer and, possibly, of infiltration, making it a critical element in achieving energy efficiency.

Wall-glazing construction means the combination of wall and *glazing* components comprising the *envelope* of a building, excluding

1 Display glazing

2 Opaque non glazed openings such as doors, vents, penetrations and shutters

The Total System U-Value and Total System SHGC of glazing must account for the combined effect of the glass and frame. The measurement of the Total System U-Value and Total System SHGC is specified in the Technical Protocols and Procedures Manual for Energy Rating of Fenestration Products of the AFRC (Australian Fenestration Rating Council).

In summer, sunlight radiates through the glazing, bringing unwanted heat into the interior. However, in winter, solar heat gains through the glazing can contribute effectively to the energy efficiency of a building where heating is desired. This is less important in non-residential commercial buildings where internal heat loads from lighting, appliances, equipment and people can be high enough to require little or no additional heating in most climates. It is recognised that for most commercial buildings in most *climate zones*, the predominate mode is cooling. Therefore, there is a greater emphasis on Total System SHGC over *Total System U-Value* in the section J provisions.

The winter sun appears lower on the horizon at any time of day than the summer sun at the same time. Between the lowest winter position and the highest summer position, there is a difference of about 47°. For unshaded glazing, the angle of the sun's rays onto the glass will affect the amount of solar heat gain transmitted through the glass. The sharper the angle (closer to 90° from the horizontal), the greater the reflectance from the surface of the glass, which results in less solar heat gain.

Generally, during the summer months, glazing facing the East and West receives the largest amount of solar gain, while glazing facing the North or South receives the least solar gain. This is in relation to the higher sun position on the horizon during the summer months, limiting the amount of solar heat transmitted through the North and South facing glazing.

Generally, during the winter months, glazing facing the North is the largest source of solar gain. Glazing facing the East and West still provide gains, however they are less than that of those available from the North due to the lower sun position during winter months. The South facing orientation provides negligible heat gains during the winter months when they are most desirable.

Orientation however is not directly important for conductance. Whether glazing faces North, South, East or West, the same amount of heat loss is calculated to occur because the loss depends on the air temperature inside the building compared to the air temperature outside, which is assumed to be similar in all directions. Good orientation however, can compensate for heat lost through conduction by providing offsetting solar gains.

The presence of shading projections and devices reduces the level of thermal performance required for glazing. However, to be effective, shading projections and devices must restrict a significant proportion of solar radiation. The projection must extend horizontally on both sides of the glazing for the same distance. Below figure explains the type of shading which would be recognised by the section J as project shading. In this figure, both E1 and E2 values must be equal or greater than the P value for the shading to be effective. If a projection shading component does not meet these criteria it cannot be included in the façade calculations and cannot offer any protection benefits for the glazing elements below it. Shading elements which do not meet these criteria will still can be recognised and being addressed under a JV3 alternative assessment approach.

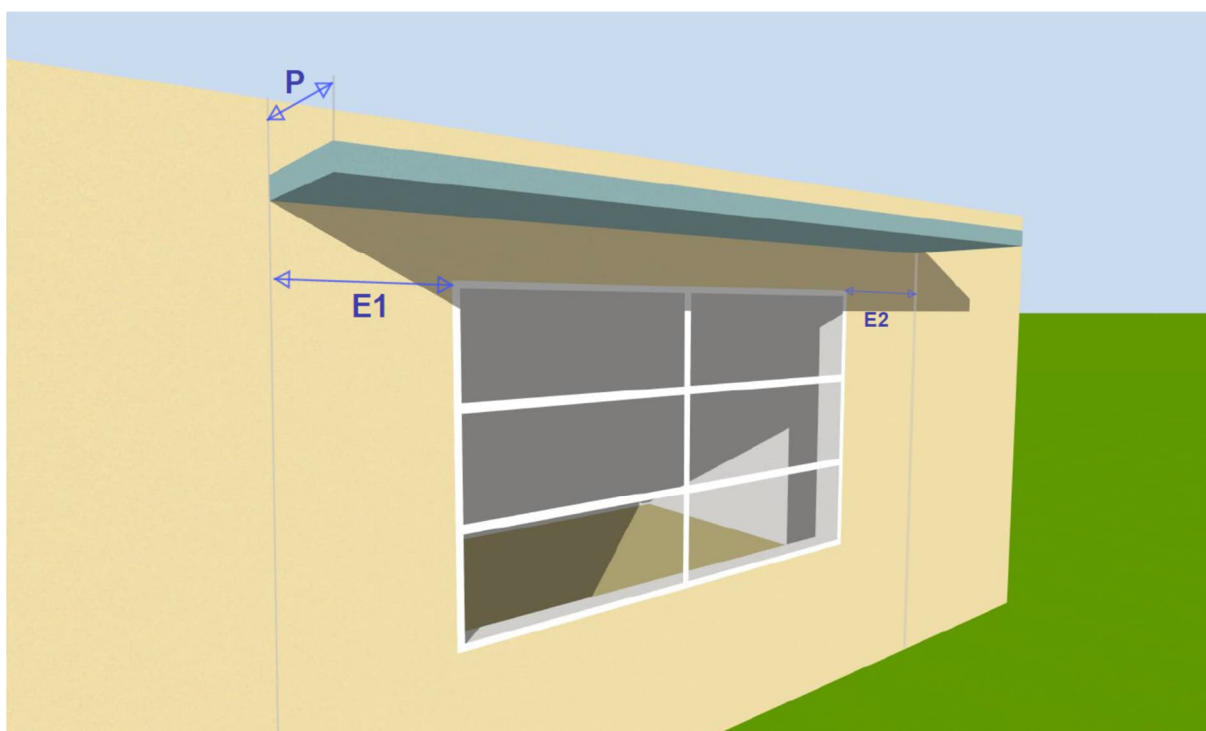

The external shading devices such as shutters, blinds, vertical or horizontal building screens with blades, battens or slats are required to restrict the amount of summer solar radiation that reaches the glazing by 80% or more. Additionally, the device must operate automatically in response to the level of solar radiation if adjustable, as devices operated manually are considered less likely to be used efficiently. Vertical shading is commonly used, however often does not meet the DTS requirements and therefore does not receive the available shading multipliers. Vertical shading provides great benefits, particularly on East and West facing facades as the sun angles are low. Therefore, vertical shading could form the basis of a Performance JV3 Solution if they are unable to restrict the amount of summer solar radiation

that reaches the glazing by 80% or more. The 80% figure acknowledges that while a device may be capable of providing 100% shade during summer, some leakage of solar radiation may occur at the sides of the device. Generally, close fitting blinds or horizontal screens that extend either side of the glazing by the same projection distance should sufficiently restrict the amount of summer solar radiation that reaches the glazing at the sides of the device. The shading projection for walls is measured from the wall face whereas for glazing the projection is measured from the glass face.

Display glazing means *glazing* used to display retail goods in a shop or showroom directly adjacent to a walkway or footpath, but not including that used in a café or restaurant.

Spandrel panels refer to the *opaque* part of a façade in curtain wall constructions which is commonly adjacent to, and integrated with, *glazing*. As per glazing, the thermal performance of a spandrel panel relates to the whole assembly, including the frame, the edge of the spandrel panel that has reduced thermal properties due to the frame, and the centre of the spandrel panel. When insulation is added in a spandrel panel, it is often added along the backside of the panel between the structural parts of the frame. Spandrel panels are typically poor for thermal bridging as the frames are generally made from highly conductive materials that allow heat to transfer from the outside into the building. Often insulation is installed on the backside of the panel, however, this does not limit the thermal bridging through the frame.

FLOORS

Unlike the roof and wall requirements, the requirements for floors address heat flow for two directions;

- 1 Vertical direction – an overall minimum Total R-Value is required and in some instances under-slab insulation with a specific R-Value.
- 2 Horizontal direction – perimeter insulation required with a specific R-Value.

The energy from a heated slab is distributed to all faces of the slab and not just to the surface within the building envelope. In a sense, the slab itself acts like a radiator. This means energy is lost from the underside of the slab and at the external edges. To control this heat loss, the slab must be insulated at the vertical edges.

Insulation for a slab-on-ground must be suitable for an external environment. In particular, it must be water resistant and still achieve the required R-Value. This can be validated by manufacturer's literature on test results.

The most problematic area is where the slab is in direct contact with the portion of the ground that is subject to significant seasonal or daily temperature variations. Conduction between

slab and ground would increase the energy needed to keep the slab at the desired temperature.

2.1 APPLICABLE PART J 1 DTS PROVISIONS

| | Building Element | Energy Efficiency Provisions | Corresponding BCA Clause |
|---|--|---|-------------------------------|
| 1 | Roof and ceiling construction of the ground floor shops as per insulation markings of this report | install additional insulation to provide a combined roof and ceiling system with total thermal resistance of R 3.7 m ² .k/w. | Part J1.3(a) |
| 2 | For the external and internal envelope walls of the ground floor shops as per insulation markings of this report | install additional insulation to provide a wall system with total thermal resistance of R 2.4 m ² .k/w. | Part J1.5(a) and Part J1.5(d) |
| 3 | For all the display glazing of the ground floor shops | install windows with Total System U-value no more than 5.8 W/m ² .k and SHGC no more than 0.81 | Part J1.5(a) |
| 4 | For the concrete slab floor of the conditioned areas of the ground floor commercial spaces as per insulation markings of this report | install additional insulation to provide a floor system with total thermal resistance of R 2.0 m ² .k/w. | Part J1.6(a) |

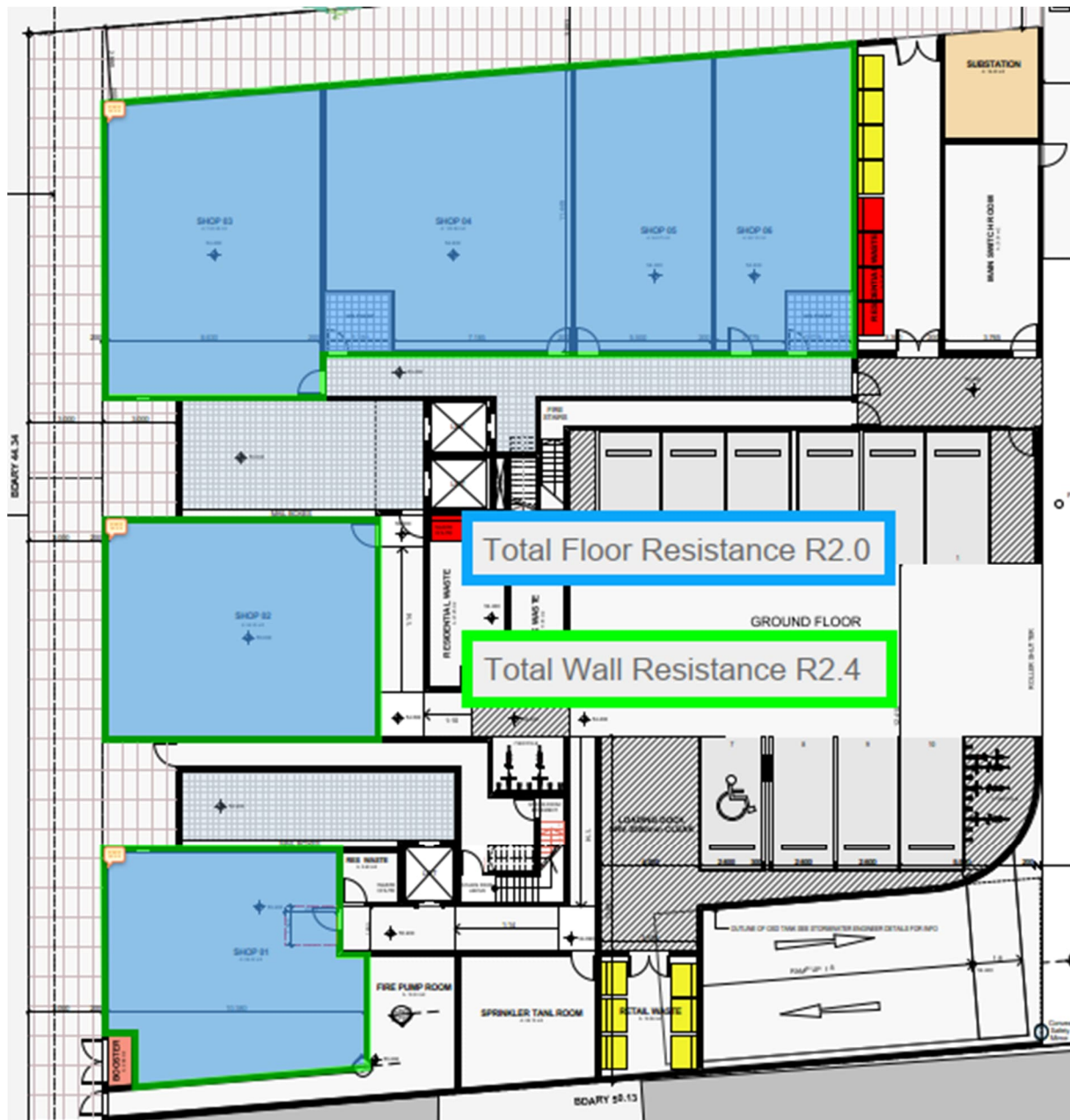

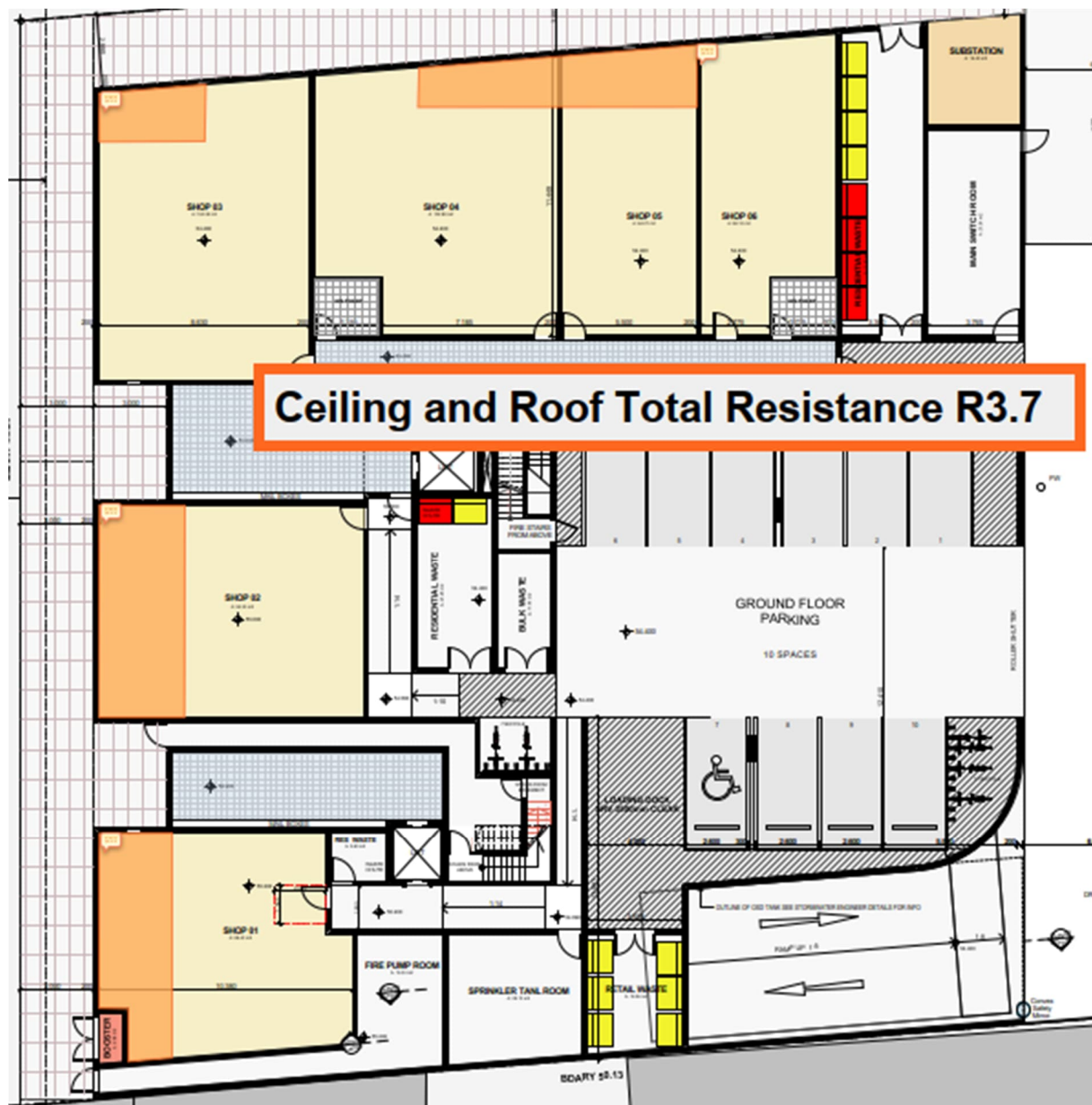

0-1 : Insulation layout Plans

2.2 PART J 3 –BUILDING SEALING

GENERAL NOTES

The intent of this part is to restrict the unintended leakage of outdoor air into the building and loss of conditioned air from the building. In addition to unnoticed air leakage, drafts caused by poorly sealed external openings and construction gaps can affect building occupants' sense of comfort, causing them to increase their use of heating and air-conditioning. Leakage of humid air into an air-conditioned building can increase energy use for dehumidification.

An external door opening to a conditioned space must have a device to prevent significant amounts of conditioned air being continuously lost. This only applies to conditioned spaces greater than 50 m². Devices that may be installed to comply with this requirement may include an airlock, self-closing door, or revolving door. Provisions for people with a disability should also be considered when selecting the device.

Reasonable judgement is required when applying sealing to windows and doors, i.e., the seal must be durable with no gaps between a conditioned and non-conditioned space.

There are a couple of exemptions to these requirements, such as for roller shutter doors or the like, that are used for out of-hours security purposes only, i.e., when conditioning is not operating. Another exemption has been granted for the main entrance to a café, restaurant or open front shop that has a 3m non-conditioned zone. Where staff are carrying trays of food or drink it may be unsafe to require an airlock, self-closing door or sliding door.

The sealing of "miscellaneous" exhaust fans, such as smaller fans used for domestic kitchen exhaust as well as sealing of roofs, walls and floors applies to the same spaces and in the same climate zones as described for rooflights. The provisions do not apply to smoke exhaust fans and the like.

Similarly to exhaust fans, an evaporative cooler represents a large opening in the building envelope. This opening needs sealing when the evaporative cooler is not in use, such as in the winter when a heating system may be operating.

Like fans, evaporative coolers must have self-closing dampers to prevent loss of heated air in those climates where heating may be needed in the winter. Typically, this would occur in climate zones 4, 5, 6, 7 and 8. However, dampers are also required in any climate zone if the space served by the evaporative cooler has a heating system, even if the space is non-habitable. This is because heated air would otherwise leak through the unsealed cooler or its ductwork.

Should a loading dock lead to a conditioned space, it must be fitted with a rapid roller door.

The exhaust fans are essentially openings in the insulated envelope, through which conditioned air will escape when they are not operating. Accordingly, the requirement is to restrict the extent of air leakage from intermittently operating fans. This can be achieved by strip damper systems that are readily available for most fan types. Alternatively, a filter system, like that used in kitchen range hoods is acceptable as they significantly restrict the flow of air when the fan is not operating.

If the fan was operating as part of the *air-conditioning* system, such as a control return air fan, an additional damper would not be required but, if one is already there for other purposes, it must close on shut down

For sealing of walls, floors and ceiling, in most instances, conventional internal fixing and finishing procedures will be sufficient to comply with the required seal, provided the linings are close fitting and trimmed by skirtings, architraves, cornices and the like. A reasonable interpretation of "close fitting" would be having a gap less than that between a closed window or door and the associated frame, which is typically 2 mm.

It is noted that some lining systems, such as plasterboard, require gaps to allow for movement of sheeting. In such instances, skirtings will be required to seal the wall and floor junctions where a fitted floor is installed and there are gaps between the subfloor and internal space. However, if the floor was a concrete slab or platform particleboard flooring then no gap would exist between the internal and external spaces and sealing is not necessary. Where it is not possible to have close fitting junctions or penetrations, expanding foam, caulking, rubber compressible strip etc. may be used to seal the gap.

2.2 APPLICABLE PART J 3 DTS PROVISIONS

| | Building Element | Energy Efficiency Provisions | Corresponding BCA Clause |
|---|---|--|--------------------------|
| 1 | All openable windows and external doors of the ground floor commercial spaces except for fire doors, smoke doors and roller shutter doors, roller shutter grille or other security door or device installed only for out-of-hours security if any | provide air seals on all edges or provide windows complying with AS 2047 The air seals can be a foam or rubber compression strip, fibrous seal or the like | Part J3.4 (a & b& c) |
| 2 | For the external entry doors to ground floor shops | provide a draft protection device for the bottom edge and for other edges provide air seals like a foam or rubber compression strip or fibrous seal. | Part J3.4 (c) |
| 3 | For entry door to ground floor shops | provide self-closing mechanism | Part J3.4 (d) |
| 4 | Exhaust fans of the ground floor shops if any | must be equipped with a self-closing damper or similar. | Part J3.5 |
| 5 | Roofs, ceilings, walls, floors, windows frames and doors frames of the ground floor shops | must be enclosed by internal lining systems that are close fitting at ceiling, wall and floor junctions OR be sealed at junctions and penetrations by close fitting architrave, skirting, cornice, expanding foam, rubber compressible strip, caulking or the like. These requirements do not apply to openings, grilles or the like required for smoke hazard management. | Part J3.6 |

2.3 PART J 5 – AIR CONDITIONING AND VENTILATION SYSTEMS

No design plans provided

2.4 PART J 6 – ARTIFICIAL LIGHTING AND POWER

GENERAL NOTES

The NCC requirements for artificial lighting and power are designed to curb unreasonable energy use in lighting systems, and the power to certain equipment, including vertical transport for nearly all building classifications.

Research indicates that lighting is estimated to be responsible for 26% of the electricity used in an office building. Lighting inefficiencies have a compounding effect in warmer climates because the extra electrical load for lighting may translate to waste heat that increases the load on the air-conditioning system. Additionally, power consumption of lifts and escalators can be excessive if inefficient systems are in place or if they are not configured to save energy when not in use.

The requirements of this part do not apply to Class 8 electricity network substations. The safety of workers requires manual lighting controls for inspection and maintenance activities of hazardous high voltage equipment.

These requirements also do not apply to the following:

1. Emergency lighting provided in accordance with Part E4.
2. Signage, display lighting within cabinets and display cases that are fixed in place.
3. Lighting for accommodation within the residential part of a detention centre.
4. A heater where the heater also emits light, such as in bathrooms.
5. Lighting of a specialist process nature such as in a surgical operating theatre, fume cupboard or clean workstation.
6. Lighting of performances such as theatrical or sporting.
7. Lighting for the permanent display and preservation of works of art or objects in a museum or gallery other than for retail sale, purchase or auction.
8. Lighting installed solely to provide photosynthetically active radiation for indoor plant growth on green walls and the like.

These are explained below:

Due to the defined terms lamp power density and illumination power density, the requirements only apply to permanently wired artificial lights. Therefore, portable lamps and lights connected by plugs to general electricity power outlets are exempt.

Emergency lighting as required by NCC Volume One Part E4 is exempt, as life safety takes precedence over energy efficiency. Lighting associated with signage, lighting within display cabinets, and lighting for cases that are fixed in place are all exempt. This concession applies to both external and internal signage and, includes lighting that highlights signs. Regarding display cases, the lighting must be within the fixed cabinet or display case to be exempted, but this cabinet does not necessarily need to be enclosed.

Lighting installed in the accommodation areas of detention centres such as jails and remand centres are also exempt as lighting requirements may differ due to safety reasons. Accommodation should be interpreted as the area specifically set aside for the detainees. Ancillary areas, such as staff common rooms and administrative areas do not receive this concession.

Lighting used for heating, such as a bathroom using heat radiated from special purpose lamps to warm room occupants are exempt. In simple terms, a higher number of watts means more heat is radiated. The use of such a system should be nominated on the building approval documents.

Lighting used for a specialised process such as lighting used for specific medical procedures, lighting in a fume cupboard or clean workstation are usually separate from the general overhead lighting and are often built into specialised equipment. Therefore, they are exempt.

Lighting used for performances such as theatrical or sporting events, which are often separately switched from any general overhead lighting, are also exempt.

Lighting used for the permanent display and preservation of works of art or objects in a museum or gallery other than those for retail sale, purchase or auction are exempt, as these lights are used to facilitate and enhance the viewing of the works of art.

Lighting installed solely to provide photosynthetically active radiation for indoor plant growth on green walls and the like often requires specific light intensities and colours to support different plant growth. Therefore, they are exempt.

BUILDINGS EXCEPT FOR SOLE-OCCUPANCY UNITS OF CLASS 2 BUILDINGS OR A CLASS 4 PART

Where lamp power density or illumination power density maybe used for sole-occupancy units in Class 2 buildings or a Class 4 part of a building, only illumination power density (IPD) can be used to measure compliance for all other applications.

Lighting in non-residential commercial buildings is progressively moving towards the use of LED lamps for general lighting and for special lighting. At present other lamps are available, but because of the shift to LED lamps for general lighting, the illumination power density levels in Part J6 reflect this newer technology. The aggregated design illumination load is the maximum load in the lamp's operational cycle.

Performance Solutions, developed to the satisfaction of the local building control authority, can be used for spaces that have complex or specific lighting needs. Alternatively, energy saved by more efficient building services or through the installation of on-site renewable energy systems may also be used to increase the allowances for lighting, again subject to the approval of the local building control authority.

The illumination power density may be increased for small rooms and a further series of adjustment factors have been included in part J6 that allow credit for additional energy control devices or to allow the use of high Colour Rendition Lights.

Occupancy sensors represent an efficient way of tailoring the lighting to the usage of the space. The fewer lights that are controlled by an individual sensor the greater the energy saved, however, there is less cost saving on the energy to offset the cost of the sensor. Therefore, there is a graduated scale of adjustment factors for the area of lights controlled.

Section J requires that an occupant activated device be installed in a sole-occupancy unit of a Class 3 building, based on the likelihood that guests may not switch off the power when leaving the room. This power includes the lighting, air-conditioning, exhaust fans and bathroom heating when the room is not occupied. The control device is not detailed so the requirements can be met by various systems such as a security device like a room key slot at the door, a motion detector, or any device or system that can monitor the occupancy of the unit. For the purpose of applying this provision, occupancy should be taken as the physical presence of people in the room rather than having someone registered or checked into the unit.

The intent of lift energy efficiency provision is to ensure lifts that are expected to have high frequency usage are the most efficient. A lower energy rating has been allowed for dedicated goods lifts, i.e., a lift used for carrying goods or materials and in which only the attendant and the persons required to load and unload are intended (or permitted) to travel. This is in recognition that these lifts have different requirements than passenger lifts.

The control devices include lighting timers, motion detectors, daylight sensors and dynamic lighting control devices.

The factors that can be applied to the maximum illumination power density are

1. Room Aspect Ratio
2. A maximum of two control devices
3. Colour Rendering Index (CRI) and Correlated colour temperature (CCT) adjustment factors

The adjustment factors are applied to the illumination power density allowance for a space. This means that, if a designer selects a less efficient light source or luminaire, compliance can still be achieved by including a supplementary control device such as an occupancy sensor or photoelectric device.

Occupancy sensors represent an efficient way of tailoring the lighting to the functional needs of the space. The fewer lights that are controlled by an individual sensor, the greater the potential energy saved, however there is less cost saving on the energy to offset the cost of each sensor. Therefore, there is a graduated scale of adjustment factors for the area of lights controlled.

Motion detectors turn on lighting in response to movement and are therefore applicable in areas that are not constantly occupied such as toilets and change rooms.

Programmable dimming systems are where pre-selected scenes or levels are automatically selected by the time of day, photoelectric cell or occupancy sensor. Examples of buildings or spaces where this may be beneficial are university buildings and classrooms. Timetables enable occupancy to be pre-determined and for lighting to be switched on in these times.

Fixed dimming is where lights are controlled to a level and that level cannot be adjusted by the user. For example, where drivers are factory set to a dimmed output to limit the light output.

Lumen depreciation dimming occurs over the lifespan of the light source. Put simply, lighting gets dimmer over time. LED or fluorescent lighting fixtures have much longer lifespans than other lighting fixtures. Therefore, illumination power density adjustment factors do not apply to tungsten, halogen or other incandescent sources to encourage the use of more efficient lighting sources.

The illumination power density adjustment factor for two stage sensor equipped lights with minimum power of 30 percent of peak power refers to both sensors integrated into the lighting system and standalone sensors as part of the lighting control system.

Daylight sensors turn off lighting when sufficient natural light from a window or roof light is present. Sensors for artificial lights located adjacent to roof lights are to be located at the discretion of the electrical engineer/lighting designer.

Dynamic dimming systems are where the lighting level is varied automatically by a photoelectric cell to either proportionally compensate for the availability of daylight or the lumen depreciation of the lamps.

LIGHT COLOUR ILLUMINATION POWER DENSITY ADJUSTMENT FACTOR

The maximum illumination power density may be increased by dividing it by the illumination power density adjustment factor. There are two possible adjustments for light colour, one regarding CRI and one regarding CCT.

CRI is the measurement of how colours look under a light source when compared with sunlight and is measured from 0-100. A CRI of 100 means that the colours appear the same as they would under sunlight. For lighting with a CRI greater than or equal to 90, the maximum illumination power density will increase once divided by the adjustment factor of 0.9.

CCT defines the colour appearance and is defined in degrees Kelvin. A warm light is approximately 3500 K and below, moving to brighter, whiter and 'cooler' as the degrees increase. A warmer light is favoured in the DTS requirements and therefore has more power allowance.

If tuneable luminaires achieve both ≤ 3500 K and ≥ 4500 , the $\leq 3,000$ K adjustment factor would be appropriate. The intent is to prevent designers using cool/blue-tinge daylight luminaires to achieve energy efficiencies. Tuneable luminaires are top of the range and most preferable. Therefore, they should be rewarded for the capacity achieving $\leq 3,500$ K and not penalised for the capacity being $\geq 4,500$ K.

Energy efficiency measures for lifts prescribe both operational and standby/idle lift operation energy efficiency measures. A lower energy rating has been allowed for dedicated goods lifts. This is in recognition that these lifts have different requirements to passenger lifts. Dedicated goods lifts are lifts used for carrying goods or materials and in which only the attendant and the persons required to load and unload are intended (or permitted) to travel. Lifts that are intended as passenger lifts, that occasionally carry goods or materials do not fall under this category.

LIGHTING AND POWER CONTROL DEVICES

Compliance with the requirements of this specification should be verified and substantiated by manufacturer's data sheets during the building approval process. Verification would be like current approval processes for emergency lighting where details of the intended systems form an integral part of the approval process and approved documentation.

TIMERS

A lighting timer is installed so that artificial lighting needed only for transiting between occupied parts of a building will operate on demand before turning off automatically after a reasonable time has passed.

The provisions specify that a timer switch needs to be available within 2 m of every entry door and visible when the space is not artificially lit. The area controlled by a single push button timer is limited to 100 m² to avoid wasteful energy use. Even so, at least 5% of lights in areas larger than 25 m² must operate separately from the timer to allow a constant low level of lighting for people to enter the space safely. The 5% of lighting that can remain active can usually be achieved by an exit sign or similar fitting. The percentage applies to numbers of lights and not to the energy used or illumination produced by the lighting.

TIME SWITCHES

Time switches are intended to turn off the power automatically. They must be programmed to accommodate the needs of the specific occupancy. However, the program must be capable of turning off the system after normal occupation has finished.

The term 'normal occupation' would, for example, also include suitable allowance for after-hours cleaning and other building functions outside the traditional 9am to 5pm operation of business premises.

MOTION DETECTORS

Motion detectors have many advantages over other control devices. For example, a person entering a space does not need to find the button to switch on the lights. The motion detector requirements for lighting include movement sensing means, detection thresholds, maximum areas that an individual detector can control, maximum number of lights that can be controlled by a detector, how long they can operate the lights after activation, and override facilities.

DAYLIGHT SENSOR AND DYNAMIC LIGHTING CONTROL DEVICES

The daylight and dynamic lighting sensors are designed to respond to changes in the illumination levels within a designated area.

The following control devices must comply with Specification listed in the Conclusion section of this report "LIGHTING AND POWER CONTROL DEVICES REQUIREMENTS":

1. Lighting timers.
2. Motion detectors.
3. Daylight sensors and dynamic lighting control devices.

A maximum of two illumination power density adjustment factors for a control device can be applied to an area. The adjustment factor does not apply to tungsten, halogen or other incandescent sources. The illumination power density adjustment factor is only applied to lights controlled by daylight sensors between 8:00 AM and 7:00 PM.

2.4 APPLICABLE PART J 6 DTS PROVISIONS

| | Building Element | Energy Efficiency Provisions | Corresponding BCA Clause |
|---|---|--|--------------------------|
| 1 | For the lighting electrical power of internal areas of the Proposed Development | maximum design power allowed is 13080 Watts. | Part J6.2 (b) |
| 2 | For all the lighting of all internal areas of the Proposed Development | every room must be individually operated by a switch or other control devices or both. | Part J6.3 (a) |
| 3 | All light switches or other control devices of the Proposed Development | must be located in the same room being switched or in an adjacent room or space from where 90% of the lighting being switched is visible. | Part J6.3 (c)(i) |
| 4 | All light switches or other control devices of the Proposed Development | must control lighting of no more than 250 m ² of area. | Part J6.3 (c)(ii) |
| 5 | For at least 95% of the light fittings in the building | install a time switch or an occupant sensing device such as a security key card reader that registers a person entering and leaving the building or a motion detector. | Part J6.3 (d) |
| 6 | Artificial lighting of a foyer, corridor and other circulation spaces of the Proposed Development if it is more than 250 W within a single zone and it is adjacent to windows | must be controlled by a daylight sensor and dynamic lighting control device. | Part J6.3 (g) |

| | | | |
|----|--|--|---------------|
| 7 | Interior decorative and display lighting if installed for the shops | must be separately controlled from other artificial lighting and by a manual switch for each area (other than when the operating times of the display are the same in a number of areas such as in a museum, art gallery or the like) and a time switch if the display lighting exceeds 1kW. | Part J6.4(a) |
| 8 | Windows display lighting if installed | must be controlled separately from other display lighting. | Part J6.4(b) |
| 9 | Exterior artificial lighting attached to or directed at the facade of a building | must be controlled by either a daylight sensor or a time switch which is capable of being pre-programmed for different times of the day on variable days. | J6.5 (a) (i) |
| 10 | If the exterior artificial lighting above exceeds 100 W of power unless for emergency lighting | use LED luminaires for 90% of the total lighting load or use motion sensors for the light control. Install a separate time switch if it is used for decorative purposes such as façade or signage lighting. | J6.5 (a) (ii) |
| 11 | If installing boiling water or chilled water storage unit for the shops | install a time switch for the power supply. | Part J6.6 |

2.5 PART J 7 – HEATED WATER SUPPLY AND SWIMMING POOL AND SPA POOL PLANT

GENERAL NOTES

A heated water supply system is a significant user of energy in a building and, although there is only limited data on pools and spas, their energy use is also significant.

A heated water supply system for food preparation and sanitary purposes must be designed and installed in accordance with Part B2 of NCC Volume Three – Plumbing Code of Australia.

2.6 PART J 8 – FACILITIES FOR ENERGY MONITORING

GENERAL NOTES

The emphasis for Part J8 is on being able to maintain the required level of performance. To achieve this, consideration needs to be given to ensuring that there are adequate provisions made in the design for monitoring facilities so that excessive energy use can be detected and rectified.

The intent of this Part is to ensure the building is designed to enable energy monitoring to be carried out easily. Building owners and designers should appreciate that effective design is

concerned not only with the needs of the building occupants but also with the ongoing operation of the building infrastructure. The intent of requiring monitoring facilities is to enable information on the energy consumption of the building or its main services to be provided to identify and rectify any excessive use of energy.

The access for maintenance and power monitoring procedures for Class 8 electricity network substations have inherent and critical characteristics that either supersede or vary from the procedures adopted and applied to other buildings. Therefore, Part J8 does not apply to such buildings.

In order for maintenance personnel to ensure that active energy efficiency items and systems continue to operate at their required level of performance, they need to know the energy usage of the building over time and also the usage of individual services in a large building. To facilitate this outcome, the data collected by energy meters is to be made readily accessible to personnel without requiring the physical inspection of meters. The data must be transmitted to a communications platform (e.g., a computer) in a format (e.g., a .csv file) that allows for its analysis by maintenance personnel.

The scope of the facilities required for energy monitoring varies from recording the total electricity and gas consumption of a relatively small building to individual monitoring of the major services in a larger building.

Most smaller buildings would have such meters supplied by the utilities company but, in the case of a campus style complex, such as a hospital, school or university, the utility company might provide only a single meter for the site.

It is not the intent of this provision to require the sub-metering of services within any SOUs within a building, or those related to the separate metering of a tenancy from a common area, only those that operate building wide.

The sub-meters monitoring the main services do not require the ability to record the data individually, however the ability to record, analyse and review the time-of-use energy consumption of these services is required in a single interface monitoring system (i.e., in 15, 30 or 60 minutes intervals). This should form part of the building solution documentation. The intent of requiring time-of-use data is to allow maintenance personal to see an energy use profile that shows energy over the course of a day or at a specific time. Therefore, excess energy (for example after hours, on hot days) can be identified and remedied. This monitoring system may take the form of a Building Management System which is likely to be used, in any case, for effective management of the building services. However, other suitable facilities to perform this function are available.

There is an exemption in subclause (d) for Class 2 buildings with a floor area of more than 2,500 m² where the total area of the common areas is less than 500 m², to recognise instances where most of the floor area is occupied by dwellings, which are likely to be individually metered. However, the requirements of (a) still apply which means that the facility to record the consumption of gas and/or electricity must still be provided.

2.6 APPLICABLE PART J 8 DTS PROVISIONS

| | Building Element | Energy Efficiency Provisions | Corresponding BCA Clause |
|---|------------------------------|---|--------------------------|
| 1 | For the Proposed Development | install energy meter which are configured to record the time-of-use consumption of gas and electricity. | Part J8.3 (a) |
| 2 | For the Proposed Development | <p>Provide facilities to record the energy consumption of the following items individually;</p> <ul style="list-style-type: none"> • air-conditioning plant including, where appropriate, heating plant, cooling plant and air handling fans • artificial lighting • appliance power • central hot water supply • internal transport devices including lifts, escalators and travellers where there is more than one serving the building • other ancillary plant. <p>These energy meters must be interlinked by a communication system that collates the time-of-use energy consumption data to a single interface monitoring system where it can be stored, analysed and reviewed</p> | Part J8.3(b) |

3.0 SUMMARY AND CONCLUSIONS

Considering the design elements nominated on the Proposed Development provided by “[Architecture Design Studio](#)” the following can be concluded for the Proposed Development to meet the Deemed to Satisfy requirements of Section J of the Building Code of Australia 2019, Energy Efficiency;

- 1 For roof and ceiling construction of the ground floor shops as per insulation markings of this report, install additional insulation to provide a combined roof and ceiling system with total thermal resistance of $R\ 3.7\ m^2.k/w$.
- 2 For the external and internal envelope walls of the ground floor shops as per insulation markings of this report, install additional insulation to provide a wall system with total thermal resistance of $R\ 2.4\ m^2.k/w$.
- 3 For glazed envelope elements of the ground floor shops, install windows with Total System U-value no more than $5.80\ W/m^2.k$ and SHGC no more than 0.81
- 4 For the concrete slab floor of the ground floor shops as per insulation markings of this report, install additional insulation to provide a floor system with total thermal resistance of $R\ 2.0\ m^2.k/w$.
- 5 Installed insulation must comply with AS/NZS 4859.1:2018 and be installed in such a way to meet the following requirements:
 - a. The insulation must abut or overlap adjoining insulation other than at supporting members such as studs, noggins, joists, furring channels and the like where the insulation must be against the member.
 - b. The installed insulation must form a continuous barrier with ceiling, walls, bulkheads, floors or the like that inherently contribute to the thermal barrier while does not affect the safe and effective operation of a service or fitting.
 - c. The bulk insulation must maintain its position and thickness other than when it is compressed between cladding and supporting members, water pipes, electrical cabling or the like. In a ceiling, where there is no bulk insulation or reflective insulation in the wall beneath, it overlaps the wall by not less than 50 mm.
 - d. Reflective insulation must be installed with the necessary airspace to achieve the required R Value and be adequately supported by framing members. Each adjoining sheet of reflective membrane must be overlapped by not less than 50 mm or tapped together. It must be closely fitted against any penetration, door or window opening.
- 6 For all openable windows and external doors of the ground floor shops except for fire doors, smoke doors and roller shutter doors, roller shutter grille or other security door or device installed only for out-of-hours security if any, provide air seals on all edges or provide windows complying with AS 2047. The air seals can be a foam or rubber compression strip, fibrous seal or the like.
- 7 For the external entry doors to ground floor shops provide a draft protection device for the bottom edge and for other edges provide air seals like a foam or rubber compression strip or fibrous seal.
- 8 For entry door to ground floor shops, provide self-closing mechanism.

- 9 Exhaust fans of the ground floor shops if any, must be equipped with a self-closing damper or similar.
- 10 Roofs, ceilings, walls, floors, windows frames and doors frames of the ground floor shops must be enclosed by internal lining systems that are close fitting at ceiling, wall and floor junctions OR be sealed at junctions and penetrations by close fitting architrave, skirting, cornice, expanding foam, rubber compressible strip, caulking or the like. These requirements do not apply to openings, grilles or the like required for smoke hazard management.
- 11 For the lighting electrical power of internal areas of the Proposed Development maximum design power allowed is 13080 Watts.
- 12 For all the lighting of all internal areas of the Proposed Development every room must be individually operated by a switch or other control devices or both
- 13 All light switches or other control devices of the Proposed Development must be located in the same room being switched or in an adjacent room or space from where 90% of the lighting being switched is visible.
- 14 All light switches or other control devices of the Proposed Development must control lighting of no more than 250 m² of area.
- 15 All lighting and power control devices of the Proposed Development including timers, time switches, motion detectors and daylight control devices must follow the guidelines and specifications outlined in lighting and power control devices requirements section of this report immediately after this conclusion.
- 16 For at least 95% of the light fittings in the building install a time switch or an occupant sensing device such as a security key card reader that registers a person entering and leaving the building or a motion detector.
- 17 Artificial lighting of a foyer, corridor and other circulation spaces of the Proposed Development if it is more than 250 W within a single zone and it is adjacent to windows must be controlled by a daylight sensor and dynamic lighting control device.
- 18 Interior decorative and display lighting if installed for the Proposed Development, must be separately controlled from other artificial lighting and by a manual switch for each area (other than when the operating times of the display are the same in a number of areas such as in a museum, art gallery or the like) and a time switch if the display lighting exceeds 1kW.
- 19 Windows display lighting if installed must be controlled separately from other display lighting.
- 20 Exterior artificial lighting attached to or directed at the facade of a building must be controlled by either a daylight sensor or a time switch which is capable of being pre-programmed for different times of the day on variable days.
- 21 If the exterior artificial lighting above exceeds 100 W of power unless for emergency lighting use LED luminaires for 90% of the total lighting load or use motion sensors for the light control. Install a separate time switch if it is used for decorative purposes such as façade or signage lighting.
- 22 If installing boiling water or chilled water storage unit, install a time switch for the power supply.

- 23 For the Proposed Development install energy meter which are configured to record the time-of-use consumption of gas and electricity.
- 24 For the Proposed Development Provide facilities to record the energy consumption of the following items individually;
 - a. air-conditioning plant including, where appropriate, heating plant, cooling plant and air handling fans
 - b. artificial lighting
 - c. appliance power
 - d. central hot water supply
 - e. internal transport devices including lifts, escalators and travelators where there is more than one serving the building
 - f. other ancillary plant
- 25 These energy meters must be interlinked by a communication system that collates the time-of-use energy consumption data to a single interface monitoring system where it can be stored, analysed and reviewed

LIGHTING AND POWER CONTROL DEVICES REQUIREMENTS

LIGHTING TIMERS' REQUIREMENTS

1. must be located within 2 m of every entry door to the space; and
2. have an indicator light that is illuminated when the artificial lighting is off; and
3. not control more than
 - a. an area of 100 m² with a single push button timer; and
 - b. 95% of the lights in spaces of area more than 25 m²; and
4. be capable of maintaining the artificial lighting
 - a. for not less than 5 minutes; and
 - b. for not more than 12 hours if the timer is reset.

TIME SWITCH REQUIREMENTS

1. A time switch must be
 - a. capable of switching on and off electric power at variable pre-programmed times and on variable pre-programmed days; and
 - b. configured so that the lights are switched off at any time the space is designated to be unoccupied.
2. A time switch for internal lighting must be capable of being overridden by—
 - a. a means of turning the lights on, either by—
 - i. a manual switch, remote control or an occupant sensing device that on sensing a person's presence, overrides the time switch for a period of up to 2 hours, after which if there is no further presence detected, the time switch must resume control; or
 - ii. an occupant sensing device that overrides the time switch upon a person's entry and returns control to the time switch upon the person's exiting, such as a security card reader or remote control; and
 - b. a manual "off" switch.
3. A time switch for external lighting must be—
 - a. configured to limit the period the system is switched on to between 30 minutes before sunset and 30 minutes after sunrise is determined or detected including any pre-programmed period between these times; and
 - b. capable of being overridden by a manual switch, remote control or a security access system for a period of up to 8 hours, after which the time switch must resume control.

4. A time switch for boiling water or chilled water storage units must be capable of being overridden by a manual switch or a security access system that senses a person's presence, overrides for a period

MOTION DETECTOR REQUIREMENTS

1. In a Class 2, 3 or 9c residential care building other than within a sole-occupancy unit, a motion detector must—
 - a. be capable of sensing movement such as by infra-red, ultrasonic or microwave detection or by a combination of these means; and
 - b. be capable of detecting a person before they are 1 m into the space; and
 - c. other than within a sole-occupancy unit of a Class 3 building, not control more than—
 - i. an area of 100 m²; and
 - ii. 95% of the lights in spaces of area more than 25 m²; and
 - d. be configured so that the lights are turned off when the space is unoccupied for more than 15 minutes; and
 - e. be capable of being overridden by a manual switch only enabling the lights to be turned off.
2. In a Class 5, 6, 7, 8, 9a or 9b building, a motion detector must—
 - a. be capable of sensing movement such as by infra-red, ultrasonic or microwave detection or by a combination of these means; and
 - b. be capable of detecting—
 - i. a person before they have entered 1 m into the space; and
 - ii. movement of 500 mm within the useable part of the space; and
 - c. not control more than—
 - i. in other than a car park, an area of 500 m² with a single sensor or group of parallel sensors; and
 - ii. 75% of the lights in spaces using high intensity discharge; and
 - d. be configured so that the lights are turned off when the space is unoccupied for more than 15 minutes; and
 - e. be capable of being overridden by a manual switch that only enables the lights to be turned off.
3. When outside a building, a motion detector must—
 - a. be capable of sensing movement such as by pressure, infra-red, ultrasonic or microwave detection or by a combination of these means; and
 - b. be capable of detecting a person within a distance from the light equal to—

- i. twice the mounting height; or
 - ii. 80% of the ground area covered by the light's beam; and
 - c. not control more than five lights; and
 - d. be operated in series with a photoelectric cell or astronomical time switch so that the light will not operate in daylight hours; and
 - e. be configured so that the lights are turned off when the area is unoccupied for more than 15 minutes; and
 - f. have a manual override switch which is reset after a maximum period of 4 hours.
4. When in a fire-isolated stairway, fire-isolated passageway or fire-isolated ramp, a motion detector must—
- a. be capable of sensing movement such as by infra-red, ultrasonic or microwave detection or by a combination of these means; and
 - b. be capable of detecting—
 - i. movement of 500 mm within the useable part of the space; and
 - ii. a person before they have entered 1 m into the space; and
 - c. be configured so that the lights dim to a 30% peak power or less when the space is unoccupied for more than 15 minutes.

DAYLIGHT SENSOR AND DYNAMIC LIGHTING CONTROL DEVICE REQUIREMENTS

1. A daylight sensor and dynamic control device for artificial lighting must—
- a. for switching on and off—
 - i. be capable of having the switching level set point adjusted between 50 and 1000 lux; and
 - ii. have—
 - 1. a delay of more than 2 minutes; and
 - 2. a differential of more than 100 lux for a sensor controlling high pressure discharge lighting, and 50 lux for a sensor controlling other than high pressure discharge lighting; and
 - b. for dimmed or stepped switching, be capable of reducing the power consumed by the controlled lighting in proportion to the incident daylight on the working plane either—
 - i. continuously down to a power consumption that is less than 50% of full power; or
 - ii. in no less than 4 steps down to a power consumption that is less than 50% of full power.

2. Where a daylight sensor and dynamic control device has a manual override switch, the manual override switch must not be able to switch the lights permanently on or bypass the lighting controls.

Below image depicts requirements of item 3 b for motion detectors;

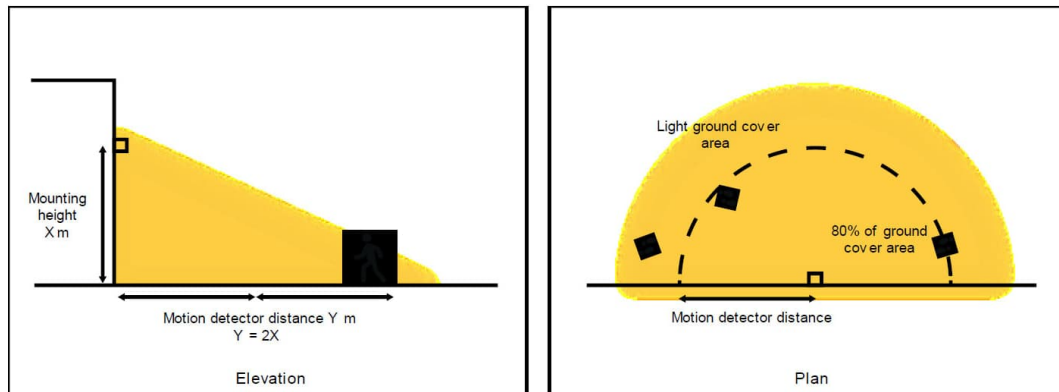

4.0 APPENDIX

This section of the report demonstrates the results of employing BCA Calculators for Facade elements like walls and windows, Lighting Power, Loss of Ceiling Insulation Table and other referenced calculations and plans in this report.

As per Clause A2.2 (a) of the Building Code of Australia, we recommend that a site inspection is undertaken by the assessors of this Report prior to the issue of an occupation certificate by the certifying authority. This is to ascertain complete compliance with the Building Code of Australia and its regulatory standards during the construction phase of the Proposed Development. Thorough assessment will be made by the inspector to assist the development in securing compliance certification from the relevant PCA or Council Authority.



Non-residential Lighting

Class 3 and 5-9 buildings



[Main Menu](#)

Help

Multiple Lighting Systems Calculator

Calculator

| Building name/description | | | Classification |
|---|----|--------------------------|----------------|
| EC - 3857 - 892-894 Canterbury Road Lakemba | | | Class 6 |
| Number of rows preferred in table below | 28 | (as currently displayed) | |

[illegible]



Non-residential Lighting

Class 3 and 5-9 buildings



Main Menu

Help

Multiple Lighting Systems Calculator

Calculator

Building name/description

EC - 3857 - 892-894 Canterbury Road Lakemba

Classification

Class 6

Number of rows preferred in table below

28

(as currently displayed)

| ID | Description | Floor area of the space | Perimeter of the space | Floor to ceiling height | Design Illumination Power Load | Space | Illuminance | | Adjustment Factor One | | | Adjustment Factor Two | | | Light Colour Adjustment Factors | | SATISFIES PART J6.2 | |
|----|---|-------------------------|------------------------|-------------------------|--------------------------------|--|--------------------|-----------------------|-----------------------|----------------|----------------------|-----------------------|----------------|----------------------|------------------------------------|------------------------------------|--|--|
| | | | | | | | Designed Lux Level | Recommended Lux Level | Adjustment Factor One | Dimming % Area | Illuminance Turndown | Adjustment Factor Two | Dimming % Area | Illuminance Turndown | Light Colour Adjustment Factor One | Light Colour Adjustment Factor Two | System Illumination Power Load Allowance | Lighting System Share of % of Aggregate Allowance Used |
| 17 | Ground Floor Residential Waste next to Shop 1 | 4.4 m ² | 8 m | 3.1 m | 1 W | Storage | | | | | | | | | | | 13 W | 4% of 0% |
| 18 | Ground Floor Fire Pump Room | 29.3 m ² | 39 m | 3.1 m | 1 W | Plant room where an average of 160 lx vertical illuminance is required on a vertical panel such as in switch rooms | | | | | | | | | | | 202 W | 4% of 0% |
| 19 | Ground Floor Sprinkler Tank Room | 27.8 m ² | 21 m | 3.1 m | 1 W | Control room, switch room, and the like - intermittent monitoring | | | | | | | | | | | 130 W | 4% of 0% |
| 20 | Ground Floor Retail Waste | 18.3 m ² | 17 m | 3.1 m | 1 W | Storage | | | | | | | | | | | 44 W | 4% of 0% |
| 21 | Ground Floor Shop 1 | 85.9 m ² | 39 m | 3.1 m | 1 W | Restaurant, café, bar, hotel lounge and a space for the serving and consumption of food or drinks | | | | | | | | | | | 1624 W | 4% of 0% |
| 22 | Ground Floor Shop 2 | 93.8 m ² | 39 m | 3.3 m | 1 W | Restaurant, café, bar, hotel lounge and a space for the serving and consumption of food or drinks | | | | | | | | | | | 1774 W | 4% of 0% |
| 23 | Ground Floor Shop 3 | 103.7 m ² | 41 m | 2.7 m | 1 W | Restaurant, café, bar, hotel lounge and a space for the serving and consumption of food or drinks | | | | | | | | | | | 1793 W | 4% of 0% |
| 24 | Ground Floor Shop 4 | 102.2 m ² | 42 m | 3.3 m | 1 W | Restaurant, café, bar, hotel lounge and a space for the serving and consumption of food or drinks | | | | | | | | | | | 1908 W | 4% of 0% |
| 25 | Ground Floor Shop 5 | 63.8 m ² | 34 m | 3.3 m | 1 W | Restaurant, café, bar, hotel lounge and a space for the serving and consumption of food or drinks | | | | | | | | | | | 1294 W | 4% of 0% |
| 26 | Ground Floor Shop 6 | 59.5 m ² | 35 m | 3.3 m | 1 W | Restaurant, café, bar, hotel lounge and a space for the serving and consumption of food or drinks | | | | | | | | | | | 1243 W | 4% of 0% |
| 27 | Ground Floor Toilet Shop 4 | 6.1 m ² | 10 m | 3.3 m | 1 W | Toilet, locker room, staff room, rest room and the like | | | | | | | | | | | 32 W | 4% of 0% |
| 28 | Ground Floor Toilet Shop 6 | 6.1 m ² | 10 m | 3.3 m | 1 W | Toilet, locker room, staff room, rest room and the like | | | | | | | | | | | 32 W | 4% of 0% |

Total 28 W

Total 13080 W

if inputs are valid



IMPORTANT NOTICE AND DISCLAIMER IN RESPECT OF THIS LIGHTING CALCULATOR

By accessing or using this calculator, you agree to the following: While care has been taken in the preparation of this calculator, it may not be complete or up-to-date. You can ensure that you are using a complete and up-to-date version by checking the Australian Building Codes Board website (www.abcb.gov.au). The Australian Building Codes Board, the Commonwealth of Australia and States and Territories of Australia do not accept any liability, including liability for negligence, for any loss



Non-residential Lighting

Class 3 and 5-9 buildings



Main Menu

Help

Multiple Lighting Systems Calculator

Calculator

Building name/description

EC - 3857 - 892-894 Canterbury Road Lakemba

Classification

Class 6

Number of rows preferred in table below

28

(as currently displayed)

| | | | | | | Illuminance | | Adjustment Factor One | | | Adjustment Factor Two | | | Light Colour Adjustment Factors | | SATISFIES PART J6.2 | | |
|----|-------------|-------------------------|------------------------|-------------------------|--------------------------------|-------------|--|-----------------------|-----------------------|----------------|-----------------------|-----------------------|----------------|---------------------------------|------------------------------------|------------------------------------|--|--|
| ID | Description | Floor area of the space | Perimeter of the space | Floor to ceiling height | Design Illumination Power Load | Space | Designed Lux Level | Recommended Lux Level | Adjustment Factor One | | | Adjustment Factor Two | | | Light Colour Adjustment Factor One | Light Colour Adjustment Factor Two | System Illumination Power Load Allowance | Lighting System Share of % of Aggregate Allowance Used |
| | | | | | | | These columns do not represent a requirement of the NCC and are suggestions only | | | | | | | | | | | |
| | | | | | | | | | Adjustment Factors | Dimming % Area | Illuminance Turndown | Adjustment Factors | Dimming % Area | Illuminance Turndown | | | | |

(howsoever caused), damage, injury, expense or cost incurred by any person as a result of accessing, using or relying upon this publication, to the maximum extent permitted by law. No representation or warranty is made or given as to the currency, accuracy, reliability, merchantability, fitness for any purpose or completeness of this publication or any information which may appear on any linked websites, or in other linked information sources, and all such representations and warranties are excluded to the extent permitted by law. This calculator is not legal or professional advice. Persons rely upon this calculator entirely at their own risk and must take responsibility for assessing the relevance and accuracy of the information in relation to their particular circumstances.



© Commonwealth of Australia and the States and Territories of Australia 2019, published by the Australian Building Codes Board. The material in this publication is licensed under a Creative Commons Attribution-NonCommercial 4.0 International licence, with the exception of third party materials and any trade marks. It is provided for general information only and without warranties of any kind. You may not make derivatives of this publication, but may only use a verbatim copy. More information on this CC BY ND licence is set out at the [Creative Commons Website](https://creativecommons.org/licenses/by-nc/4.0/). For information regarding this publication, see www.abcb.gov.au.